



Devonport City Council

PUBLIC NOTICE

APPLICATION FOR PLANNING PERMIT

Section 57(3) Land Use Planning Approvals Act 1993

An application for a planning permit has been made which may affect you.

Application Details

Application Number:	PA2026.0024
Proposed Use or Development:	Residential (outbuilding)
Address of the Land:	10 Rundle Road, Stony Rise
Date of Notice:	07/03/2026

You are invited to view the application and any documents and plans accompanying it on the ground floor of the paranaple centre at 137 Rooke Street, Devonport or on Council's website www.devonport.tas.gov.au

Any person may make a representation relating to the application in accordance with section 57(5) of the *Land Use Planning Approvals Act 1993*, during a period of 14 days commencing on the date of this notice.

Your representation must:

- be received by close of business on **24/03/2026**;
- be in writing; and
- addressed to the Chief Executive Officer, Devonport City Council:
 - P.O. Box 604, Devonport, Tasmania, 7310; or
 - townplanning@devonport.tas.gov.au

If you make a representation then Council must consider your submission before making its decision on the application.



10 Rundle Road Stony Rise



This map is made available for the purpose of providing access to Devonport City Council information and not as professional advice. The information contained on the map is diagrammatic only. All information should be verified on site, or with the appropriate State Government Department or Council Office, prior to being used for any purpose.

Copyright © Devonport City Council

Created: 03-03-2026 11:16:10



**Devonport
City Council**

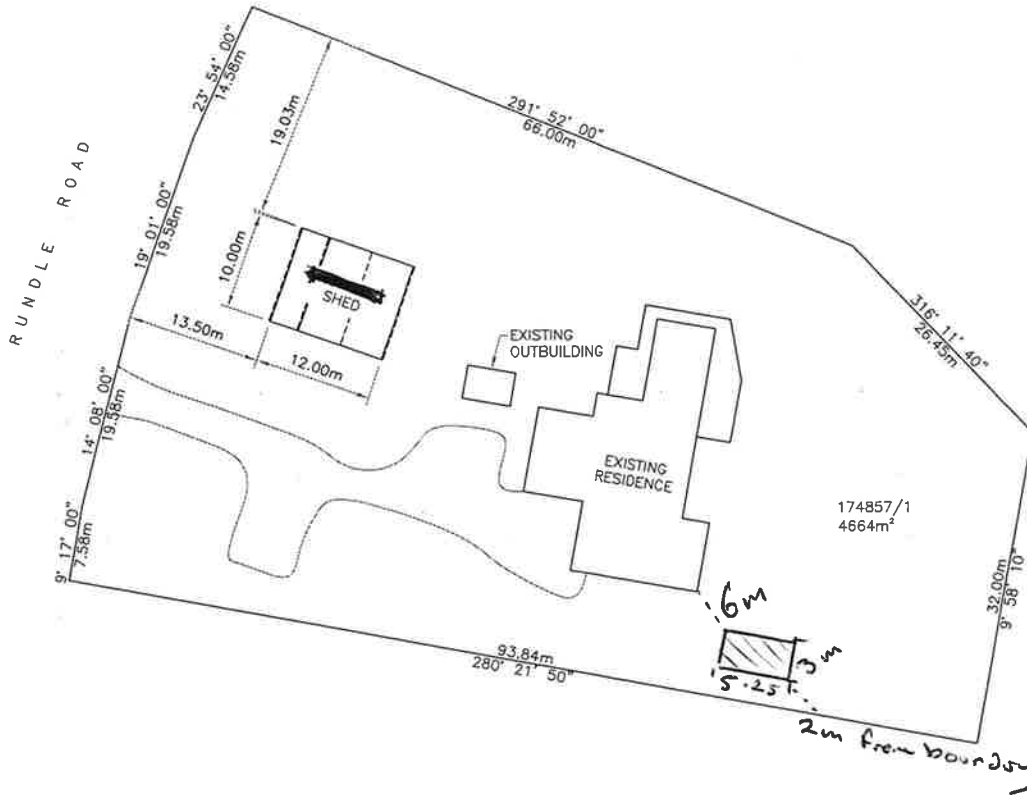

SITE PLAN

Devonport City Council
 Planning Permit
 Endorsed Plans/Documentation

Residential (outbuilding)

Planning Permit No: PA2023.0141
 Approved by: Karen Stone
 Acting Development Services Manager
 Date: 6 November 2023

Accreditation No: CC1779G

P.A. DESIGNS
 Ph: 0407 532 435
 Email: paul@pladesign.com.au

DATE	SEP 2023
DRAWN	J.R.A.
CHECKED	P.L.A.
SHEET SIZE	A3
SCALE	1 : 500

PROPOSED SHED		REV.	DATE
10 RUNDLE ROAD STONY RISE		A	19.09.23
RIAN & HAYLEY HOW			
DRAWING No.	23123-02		

GARDENSTAR Gable Truss 4.0 x 3.0 x 2.23/1.96m
 Shown In 'Cull Grey' with optional extra wall height, window, skylights, Double Door In the gable and extra Single Door.

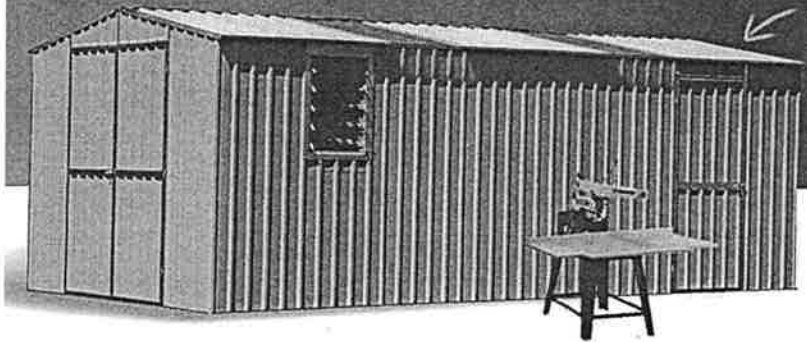

Non-standard configuration

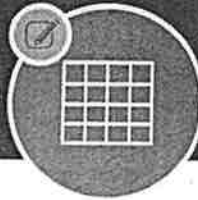

Custom GARDENSTAR



Standard configuration
 (Customise to suit your needs)

Gable Truss Sizes (m)

Length		Width of Gable		Height of Gable		Height of Wall
4.50	x	2.25	x	2.05	x	1.83
4.50	x	3.00	x	2.10	x	1.83
4.50	x	3.75	x	2.15	x	1.83
5.25	x	2.25	x	2.05	x	1.83
5.25	x	3.00	x	2.10	x	1.83
5.25	x	3.75	x	2.15	x	1.83
6.00	x	2.25	x	2.05	x	1.83
6.00	x	3.00	x	2.10	x	1.83
6.00	x	3.75	x	2.15	x	1.83
7.50	x	2.25	x	2.05	x	1.83
7.50	x	3.00	x	2.10	x	1.83
7.50	x	3.75	x	2.15	x	1.83

GARDENSTAR Gable Truss

True workshop size with endless options

- ✔ Standard with 1.5m Double Door in 6.0m length of unit
- ✔ Choice of Zinc or Color, with galvanised channel and trim
- ✔ Wall angle for neat, strong corners
- ✔ Welded Galtube truss provides roof support

Nominal dimensions only. See page 16 for base sizes
 GARDENSTAR units supplied with Concrete Anchor Kit
 Have you rebated your slab?

Manufactured in Tasmania since 1978

GARDENSTAR
 Sheds & Aviaries