



Devonport City Council

PUBLIC NOTICE

APPLICATION FOR PLANNING PERMIT

Section 57(3) Land Use Planning Approvals Act 1993

An application for a planning permit has been made which may affect you.

Application Details

Application Number:	PA2025.0100
Proposed Use or Development:	Residential (redevelopment of residential care facility)
Address of the Land:	2-14 North Street, Devonport
Date of Notice:	10/01/2026

You are invited to view the application and any documents and plans accompanying it on the ground floor of the paranaple centre at 137 Rooke Street, Devonport or on Council's website www.devonport.tas.gov.au

Any person may make a representation relating to the application in accordance with section 57(5) of the *Land Use Planning Approvals Act 1993*, during a period of 14 days commencing on the date of this notice.

Your representation must:

- be received by close of business on **27/01/2026**;
- be in writing; and
- addressed to the Chief Executive Officer, Devonport City Council:
 - P.O. Box 604, Devonport, Tasmania, 7310; or
 - townplanning@devonport.tas.gov.au

If you make a representation then Council must consider your submission before making its decision on the application.



2-14 North Street, Devonport



This map is made available for the purpose of providing access to Devonport City Council information and not as professional advice. The information contained on the map is diagrammatic only. All information should be verified on site, or with the appropriate State Government Department or Council Office, prior to being used for any purpose.



CLEMENTS STREET

BOUNDARY

8 BED EXTENSION UNDER CONSTRUCTION AS PER PLANNING PERMIT PA2A24.0168

8 BED EXTENSION

ILU 5

ILU 4

ILU 3

ILU 2

ILU 1

EXG CAR PARK

DEMOLITION TO THIS AREA AS PER OTHER PLANNING APPLICATION

AREA OF DEMOLITION WORK REFER TO STAGING DEMOLITION PLANS

OUTLINE OF PROPOSED NEW BUILDING WORKS

REFER ALSO TO DETAIL PLANS OF INDIVIDUAL STAGES OF WORKS

NORTH STREET

BOUNDARY

EXG CROSSOVER



Rev	Description	Dwn	Date
A	GENERAL REVISION		22.07.25
B	GENERAL REVISION		29.07.25
C	PLANNING APPLICATION		01.08.25

PHILIP LIGHTON ARCHITECTS

Accredited Designers: Anthony Dalgleish 567913835
Peter Gagnon CC2974
Thomas Floyd 611726668

CONTRACTOR SHALL VERIFY ALL DIMENSIONS ON SITE BEFORE COMMENCING ANY WORK OR SHOP DRAWINGS
© THIS DRAWING IS COPYRIGHT AND REMAINS THE PROPERTY OF PHILIP LIGHTON ARCHITECTS PTY LTD

Project: MEERCROFT CARE INC
MEERCROFT CARE RACF REDEVELOPMENT
2-14 NORTH STREET
DEVONPORT TAS 7310

Title: **DEMOLITION PLAN**

Issue: **PLANNING APPLICATION**

Drawn by	PH	Appr	PG	Project Number
Scale	1: 250 @ A1	Date	01.08.25	107.24163
Drawing No	SKA0.0101	Rev	C	

BOUNDARY

OCEAN VIEW FFL 6.110

BANKSIA FFL 6.110

BLUFF HAVEN FFL 6.110

PARKVIEW FFL 8.760

PARK AVENUE FFL 8.760

PARK LANE FFL 8.930

ROSE LANE FFL 8.760

LAUREL LANE GROUND FFL 8.760

CENTRAL LANE FFL 8.760

WARATAH LANE FFL 8.760

ADMINISTRATION FFL 8.760

MAIN ENTRY

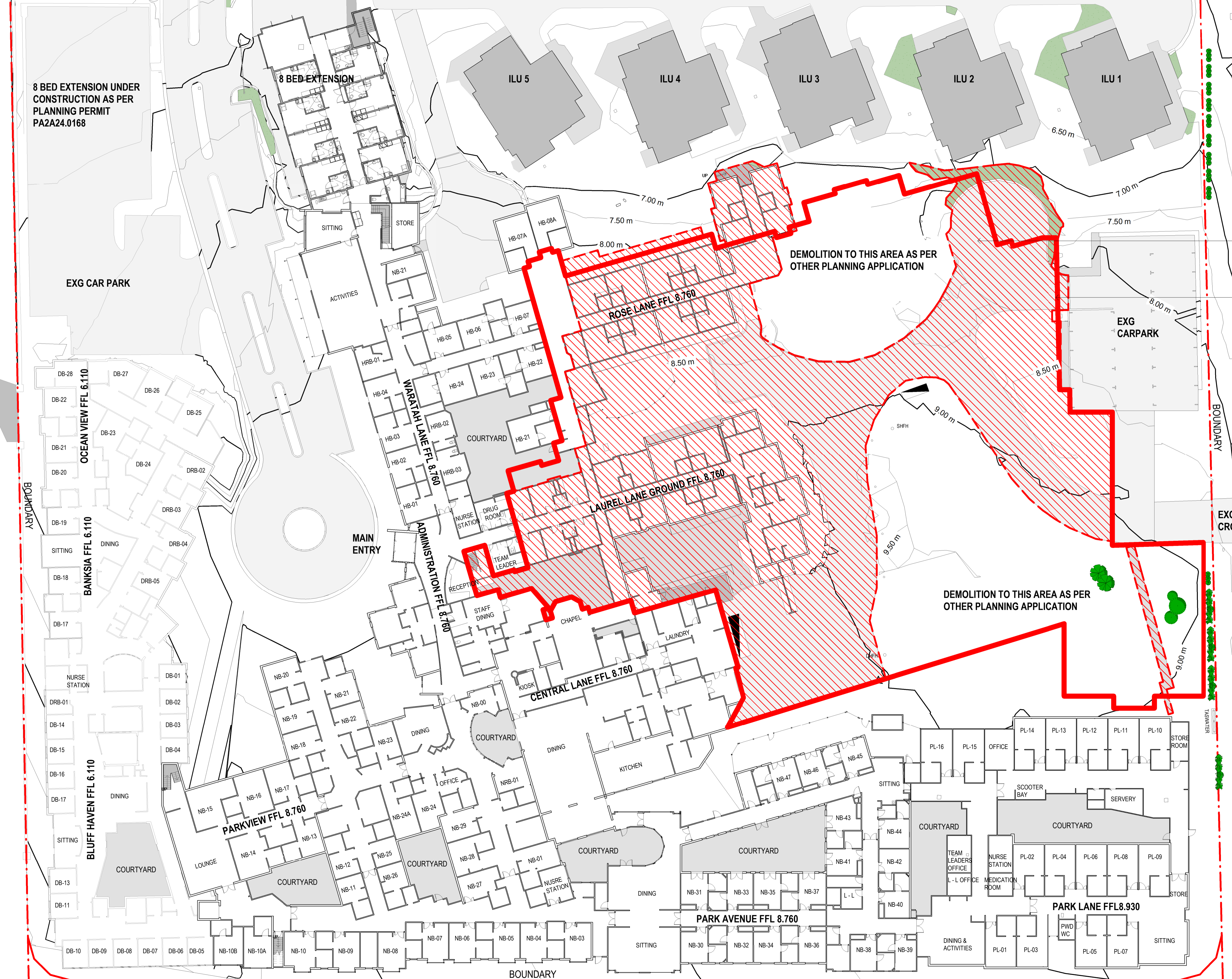

CLEMENTS STREET

BOUNDARY



8 BED EXTENSION UNDER CONSTRUCTION AS PER PLANNING PERMIT PA2A24.0168

EXG CAR PARK

OCEAN VIEW FFL 6.110

BANKSIA FFL 6.110

BLUFF HAVEN FFL 6.110

REDEVELOP AS FACILITY ADMINISTRATION TO FUTURE DETAIL LAYOUT

PARKVIEW FFL 8.760

CENTRAL LANE FFL 8.760

PARK AVENUE FFL 8.760

PARK LANE FFL 8.930

BOUNDARY

LEGEND

- RESIDENT BEDROOMS
- BEDROOM ENSUITES
- RESIDENT SOCIAL / DINING AREAS
- VISITOR BATHROOMS
- HOTEL SERVICES
- CIRCULATION
- STAFF
- EXISTING
- ADMINISTRATION FIT-OUT

REFER ALSO TO DETAIL PLANS OF INDIVIDUAL STAGES OF WORKS

NORTH STREET

BOUNDARY

EXG CROSSOVER

NEW CARPARK



0 1 2 3 4 5 10m @ 1:250

Rev	Description	Dwn	Date
A	GENERAL REVISION		22.07.25
B	GENERAL REVISION		29.07.25
C	PLANNING APPLICATION		01.08.25

PHILP LIGHTON ARCHITECTS

Accredited Designers: Anthony Dalgleish: 567913835
Peter Gagnon: 002974
Thomas Floyd: 611726668

CONTRACTOR SHALL VERIFY ALL DIMENSIONS ON SITE BEFORE COMMENCING ANY WORK OR SHOP DRAWINGS
© THIS DRAWING IS COPYRIGHT AND REMAINS THE PROPERTY OF PHILP LIGHTON ARCHITECTS PTY LTD

Project: MEERCROFT CARE INC
MEERCROFT CARE RACF REDEVELOPMENT
2-14 NORTH STREET
DEVONPORT TAS 7310

Title: **OVERALL SITE PLAN**

Issue: **PLANNING APPLICATION**

Drawn by	PH	Appr	PG	Project Number
Scale	1: 250 @ A1	Date	01.08.25	107.24163
Drawing No	SKA0.0102	Rev	C	

PHILP LIGHTON ARCHITECTS PTY LTD 2025 MEERCROFT CARE MASTERPLAN/2025/24163/01 OVERALL SITE PLAN



- LEGEND**
- RESIDENT BEDROOMS
 - BEDROOM ENSUITES
 - RESIDENT SOCIAL / DINING AREAS
 - VISITOR BATHROOMS
 - HOTEL SERVICES
 - CIRCULATION
 - STAFF
 - EXISTING
 - ADMINISTRATION FIT-OUT

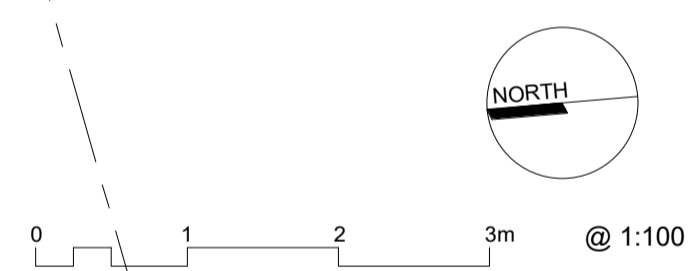

Rev	Description	Dwn	Date
A	GENERAL REVISION		22.07.25
B	GENERAL REVISION		29.07.25
C	PLANNING APPLICATION		01.08.25

PHILP LIGHTON ARCHITECTS

Accredited Designers: Anthony Dalgleish: 567913835
 Peter Gagnin: CC397A
 Thomas Floyd: 611726668

CONTRACTOR SHALL VERIFY ALL DIMENSIONS ON SITE BEFORE COMMENCING ANY WORK OR SHOP DRAWINGS
 © THIS DRAWING IS COPYRIGHT AND REMAINS THE PROPERTY OF PHILP LIGHTON ARCHITECTS PTY LTD

Project: MEERCROFT CARE INC
 MEERCROFT CARE RACF REDEVELOPMENT
 2-14 NORTH STREET
 DEVONPORT TAS 7310

Title: **STAGE 2 LAUREL LANE FIRST FLOOR PLAN**

Issue: **PLANNING APPLICATION**

Drawn by	PH	Appr	PG	Project Number
Scale	1:100 @ A1	Date	01.08.25	107.24163
Drawing No	SKA2.1012	Rev	C	

PHILP LIGHTON ARCHITECTS MEERCROFT CARE MASTERPLAN/24183/MEERCROFT CARE MASTERPLAN/1



- LEGEND**
- RESIDENT BEDROOMS
 - BEDROOM ENSUITES
 - RESIDENT SOCIAL / DINING AREAS
 - VISITOR BATHROOMS
 - HOTEL SERVICES
 - CIRCULATION
 - STAFF
 - EXISTING
 - ADMINISTRATION FIT-OUT

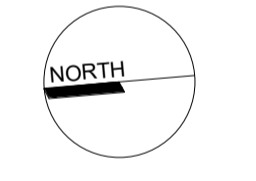

0 1 2 3m @ 1:100

Rev	Description	Dwn	Date
A	GENERAL REVISION		22.07.25
B	GENERAL REVISION		29.07.25
C	PLANNING APPLICATION		01.08.25

PHILP LIGHTON ARCHITECTS

Accredited Designers: Anthony Dalgleish 567913835
 Peter Gagnin CC3874
 Thomas Floyd 611728688

CONTRACTOR SHALL VERIFY ALL DIMENSIONS ON SITE BEFORE COMMENCING ANY WORK OR SHOP DRAWINGS
 © THIS DRAWING IS COPYRIGHT AND REMAINS THE PROPERTY OF PHILP LIGHTON ARCHITECTS PTY LTD

Project: MEERCROFT CARE INC
 MEERCROFT CARE RACF REDEVELOPMENT
 2-14 NORTH STREET
 DEVONPORT TAS 7310

Title: **STAGE 3 ROSE LANE FLOOR PLAN**

Issue: **PLANNING APPLICATION**

Drawn by	PH	Appr	PG	Project Number
Scale	1:100 @ A1	Date	01.08.25	107.24163
Drawing No	SKA3.1002	Rev	C	

PHILP LIGHTON ARCHITECTS PTY LTD 2025 01/08/25 10:30 AM MEERCROFT CARE MASTER PLAN V2 24163 107.24163

CLEMENTS STREET

BOUNDARY



NORTH STREET

BOUNDARY

EXG CROSSOVER

NEW CAR PARK



Rev	Description	Dwn	Date
A	GENERAL REVISION		22.07.25
B	GENERAL REVISION		29.07.25
C	PLANNING APPLICATION		01.08.25

PHILP LIGHTON ARCHITECTS

Accredited Designers: Anthony Dalgleish 567913835
 Peter Gagnin CC9874
 Thomas Floyd 611726668

CONTRACTOR SHALL VERIFY ALL DIMENSIONS ON SITE BEFORE COMMENCING ANY WORK OR SHOP DRAWINGS
 © THIS DRAWING IS COPYRIGHT AND REMAINS THE PROPERTY OF PHILP LIGHTON ARCHITECTS PTY LTD

Project: MEERCROFT CARE INC
 MEERCROFT CARE RACF REDEVELOPMENT
 2-14 NORTH STREET
 DEVONPORT TAS 7310

Title: **STAGE 4 HIGH CARE UNIT SITE PLAN**

Issue: **PLANNING APPLICATION**

Drawn by: PH Appr: PG Project Number: 107.24163

Scale: 1:250 @ A1 Date: 01.08.25

Drawing No: SKA4.1001 Rev: C

PHILP LIGHTON ARCHITECTS PTY LTD 2025 01/08/25 107.24163 MEERCROFT CARE MASTER PLAN 2025 24/08/25 MEERCROFT CARE MASTER PLAN



VIEW FROM SOUTH WEST CARPARK LOOKING TO HOTEL SERVICES ENTRY & SCREENED PLANT ENCLOSURE

Rev	Description	Dwn	Date
A	GENERAL REVISION		22.07.25
B	GENERAL REVISION		29.07.25
C	PLANNING APPLICATION		01.08.25

PHILP LIGHTON ARCHITECTS

Accredited Designers: Anthony Dalgleish: 567913835
Peter Gaggin: CC287A
Thomas Floyd: 611726668

CONTRACTOR SHALL VERIFY ALL DIMENSIONS ON SITE BEFORE COMMENCING ANY WORK OR SHOP DRAWINGS

© THIS DRAWING IS COPYRIGHT AND REMAINS THE PROPERTY OF PHILP LIGHTON ARCHITECTS PTY LTD

Project: MEERCROFT CARE INC
MEERCROFT CARE RACF REDEVELOPMENT
2-14 NORTH STREET
DEVONPORT TAS 7310

Title: EXTERNAL VIEW -
HOTEL SERVICES ENTRY
SOUTH WEST

Issue: PLANNING APPLICATION

Drawn by	PH	Appr	PG	Project Number
Scale		Date		107.24163
		01.08.25		
Drawing No	SKA9003			Rev
				C

PHILP LIGHTON ARCHITECTS PTY LTD 10/2025 12:18:52 PM



VIEW LOOKING SOUTH FROM COURTYARD 4 WITH LAUREL LANE LEFT & HOTEL SERVICES RIGHT
LANDSCAPING INDICATIVE ONLY

Rev	Description	Dwn	Date
A	GENERAL REVISION		22.07.25
B	GENERAL REVISION		29.07.25
C	PLANNING APPLICATION		01.08.25

PHILP LIGHTON ARCHITECTS

Accredited Designers: Anthony Dalgleish: 567913835
Peter Gaggin: CC287A
Thomas Floyd: 611728668
CONTRACTOR SHALL VERIFY ALL DIMENSIONS ON SITE
BEFORE COMMENCING ANY WORK OR SHOP DRAWINGS
© THIS DRAWING IS COPYRIGHT AND REMAINS THE
PROPERTY OF PHILP LIGHTON ARCHITECTS PTY LTD

Project: MEERCROFT CARE INC
MEERCROFT CARE RACF REDEVELOPMENT
2-14 NORTH STREET
DEVONPORT TAS 7310

Title: **EXTERNAL VIEW -
LAUREL LANE COURTYARD**

Issue: **PLANNING APPLICATION**

Drawn by	PH	Appr	PG	Project Number
Scale		Date		107.24163
Drawing No	SKA9004		Rev	C

PHILP LIGHTON ARCHITECTS PTY LTD 2025 02 25 10 58 AM

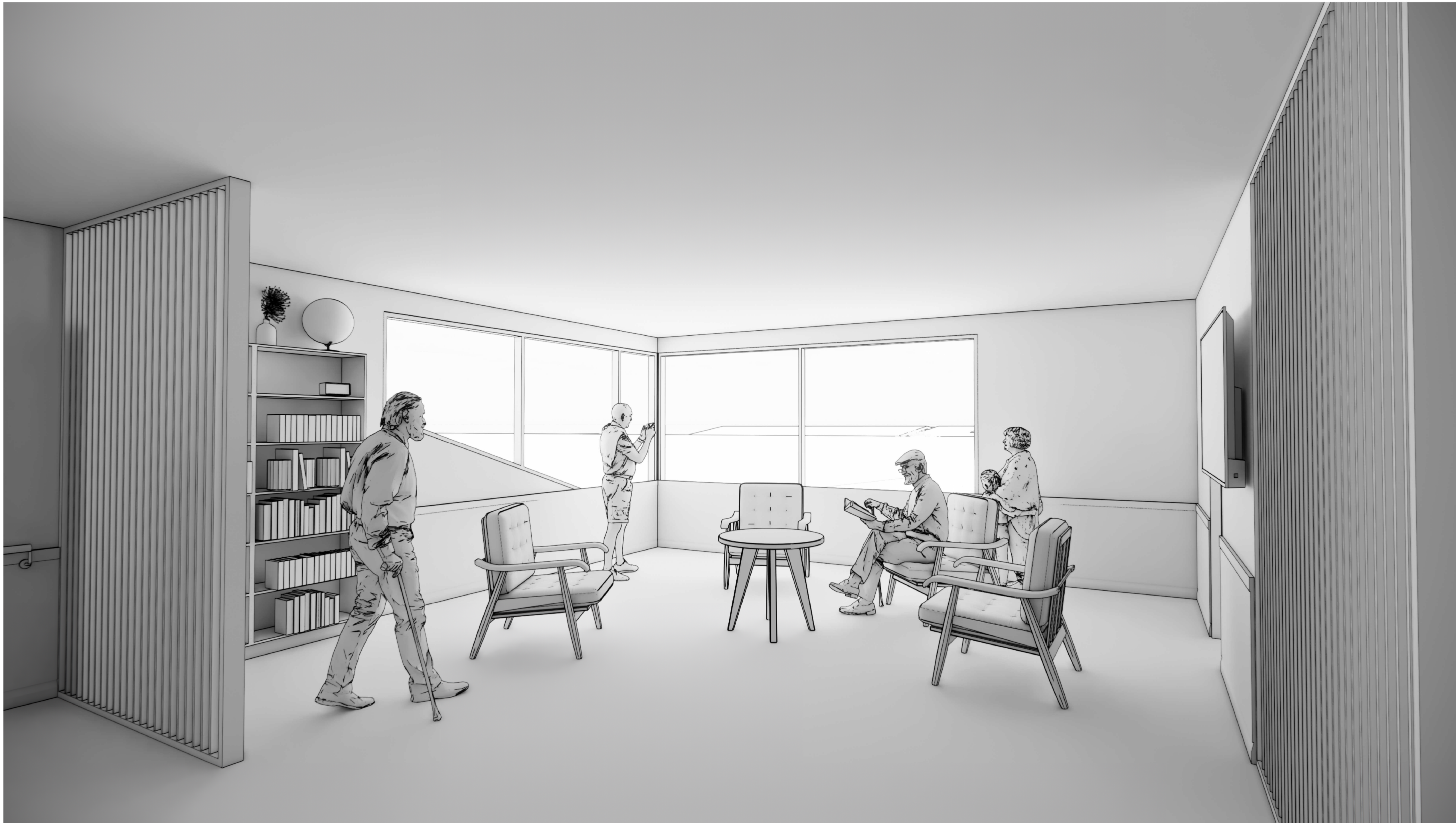

INTERIOR VIEW OF LAUREL LANE SUN ROOM LOOKING WEST

Rev	Description	Dwn	Date
A	GENERAL REVISION		22.07.25
B	GENERAL REVISION		29.07.25
C	PLANNING APPLICATION		01.08.25

PHILP LIGHTON ARCHITECTS

Accredited Designers: Anthony Dalgleish: 567913835
 Peter Gaggan: CC287A
 Thomas Floyd: 611728668

CONTRACTOR SHALL VERIFY ALL DIMENSIONS ON SITE BEFORE COMMENCING ANY WORK OR SHOP DRAWINGS
 © THIS DRAWING IS COPYRIGHT AND REMAINS THE PROPERTY OF PHILP LIGHTON ARCHITECTS PTY LTD

Project			
MEERCROFT CARE INC MEERCROFT CARE RACF REDEVELOPMENT 2-14 NORTH STREET DEVONPORT TAS 7310			
Title			
INTERNAL VIEW - LAUREL LANE SUN ROOM			
Issue			
PLANNING APPLICATION			
Drawn by	PH	Appr	PG
Scale	Date	Project Number	
	01.08.25	107.24163	
Drawing No	Rev		
SKA9007	C		

PHILP LIGHTON ARCHITECTS PTY LTD